



****AVAILABLE SEPTEMBER 2025****
****STUNNING JESMOND DENE VIEWS****
****FURNISHED** **GARAGE**** A brilliant first floor apartment, ideally located within Dulverton Court, Adderstone Crescent, Jesmond. Tucked behind St George's Church and arguably one of Newcastle's most prestigious residential addresses Adderstone Crescent is perfectly placed to give access to all Jesmond has to offer.



The apartment itself, originally constructed in 1975 boasts almost 700 Sq. ft and briefly comprises entrance lobby, entrance hall, 16ft lounge/diner with stunning views out over Jesmond Dene, fitted kitchen with appliances, two bedrooms and a stylish bathroom WC. Fully double glazed and well presented throughout and with a private 16ft garage and communal gardens, this great apartment demands an early internal inspection.

Available 6th September 2025 | £1,100pcm | First Floor Apartment | 813 Sq. ft (75.5 m2) | Two Bedrooms | 16ft Lounge/Diner with Views | Fitted Kitchen | Bathroom WC | 16ft Garage | Communal Gardens | Fully Furnished | Fantastic Location | Council Tax Band: C | EPC Rating: C

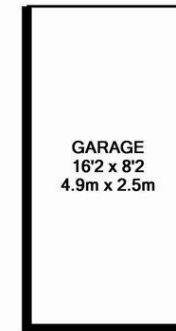
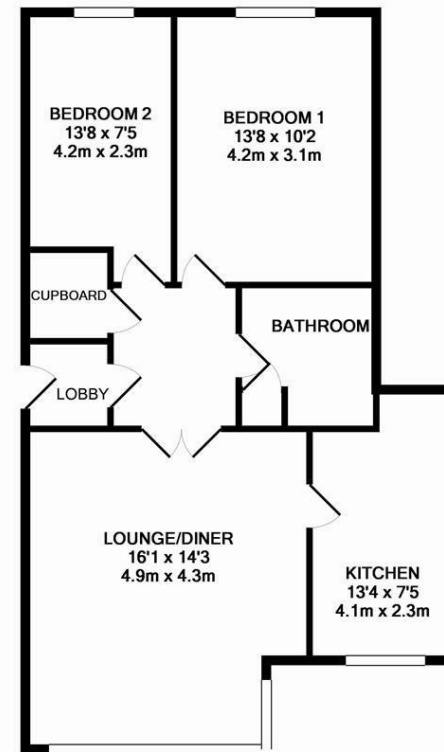

GARAGE
APPROX. FLOOR
AREA 132 SQ.FT.
(12.2 SQ.M.)



1ST FLOOR
APPROX. FLOOR
AREA 681 SQ.FT.
(63.3 SQ.M.)

TOTAL APPROX. FLOOR AREA 813 SQ.FT. (75.5 SQ.M.)

Whilst every attempt has been made to ensure the accuracy of the floor plan contained here, measurements of doors, windows, rooms and any other items are approximate and no responsibility is taken for any error, omission, or mis-statement. This plan is for illustrative purposes only and should be used as such by any prospective purchaser. The services, systems and appliances shown have not been tested and no guarantee as to their operability or efficiency can be given
 Made with Metropix ©2015

£1,100 PCM

IMPORTANT NOTE: These particulars and the descriptions and measurements herein do not constitute representation and whilst every effort has been made to ensure accuracy, this cannot be guaranteed.

